

Enclosed fork tips

Unique controls

Acid-resistant frame

Robust and reliable

Compact and manoeuvrable

Grease nipples on  
moving parts



## **AM I20/I20p**

**Stainless steel hand pallet truck (2,000 kg)**

The stainless steel version of the AM hand pallet truck is ideal for use in damp and harsh environments. The stainless steel construction provides unrivalled hygiene. A whole range of models are also available, depending on the application.

Our decades of experience in stainless steel hand pallet trucks are reflected today in reliable and robust trucks. In meat or fish processing, the chemical or pharmaceuticals sectors – our stainless steel hand pallet trucks offer the right solution.

**JUNGHEINRICH**

# AM I20/I20p

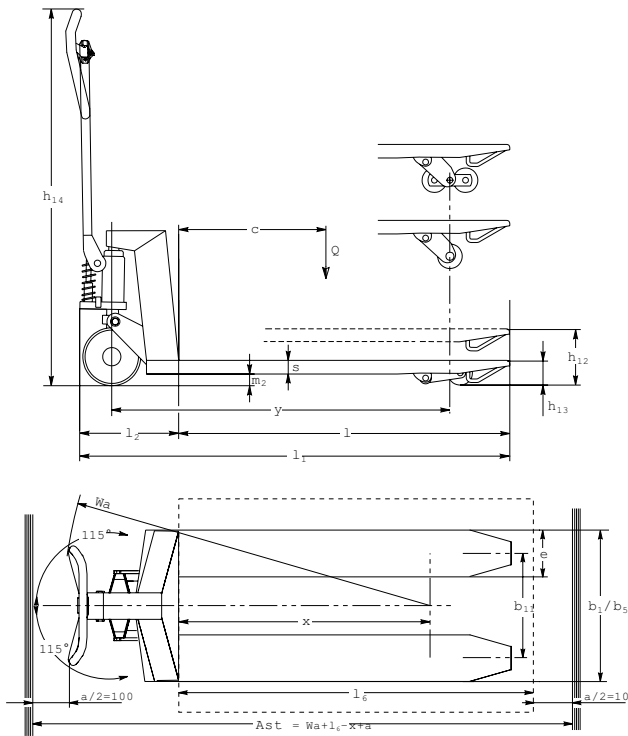

## AM I20

Not all environments require trucks to be made of 100% stainless steel. Only those parts which come into direct contact with food must be made of stainless steel. Many components however need only be moisture-repellent. Consequently, the components of the AM I20 consist of a number of different surfaces.

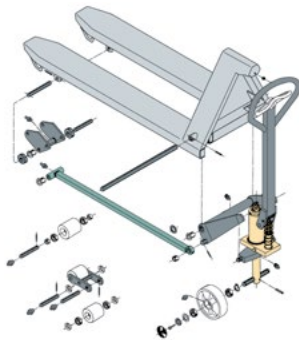

AM I20

- Electro-plating
- Chromite coating
- Stainless steel (AISI 303/304)
- Acid resistant stainless steel (AISI 316)

## AM I20p

The AM I20p is 100% rust-proof and has been designed especially for applications where hygiene is of the utmost importance and for use in particularly harsh environments. The hydraulics are protected; no foreign bodies or water can penetrate the truck.

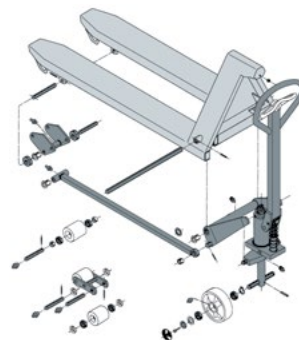

AM I20p

# Technical data in line with VDI 2198

			Jungheinrich						
			AM I20	AM I20p	AM I20	AM I20p	AM I20	AM I20p	
Identification	1.1	Manufacturer (abbreviation)							
	1.2	Model							
	1.3	Drive		manual	manual	manual	manual	manual	
	1.4	Manual, pedestrian, stand-on, seated, order picker operation		hand	hand	hand	hand	hand	
	1.5	Load capacity/rated load	Q t	2					
	1.6	Load centre distance	c mm	405	405	485	485	570	570
	1.8	Load distance	x mm	635	635	795	795	965	965
	1.9	Wheelbase	y mm	835	835	995	995	1,165	1,165
	Weights	2.1	Net weight	kg	59	59	63	63	69
2.1.1		Net weight incl. battery (see row 6.5)	kg	59	0	63	63	69	0
2.2		Axle loading, laden front/rear	kg					636 / 1,432	
2.3		Axle loading, unladen front/rear	kg					21 / 47 <sup>2)</sup>	
Wheels / frame	3.1	Tyres		N,V	N,V	N,V	N,V	N,V	
	3.2	Tyre size, front	mm	Ø 200x50					
	3.3	Tyre size, rear	mm	Ø 80x90 <sup>3)</sup>	Ø 80x90 <sup>3)</sup>	Ø 80x90 <sup>3)</sup>	Ø 80x90 <sup>3)</sup>	Ø 80x90 <sup>3)</sup>	Ø 80x90
	3.5	Wheels, number front/rear (x = driven wheels)		2/2 or 2/4					
	3.6	Tread width, front	b <sub>10</sub> mm	120					
	3.7	Tread width, rear	b <sub>11</sub> mm	360					
	Basic dimensions	4.4	Lift	h <sub>3</sub> mm	120				
4.9		Height of tiller in drive position min. / max.	h <sub>14</sub> mm	1,170					
4.14		Standing height raised	h <sub>12</sub> mm	200	205	200	205	200	205
4.15		Height, lowered	h <sub>13</sub> mm	85					
4.19		Overall length	l <sub>1</sub> mm	1,145	1,145	1,305	1,305	1,475	1,475
4.20		Length to face of forks	l <sub>2</sub> mm	340					
4.21		Overall width	b <sub>1</sub> /b <sub>2</sub> mm	520 <sup>1)</sup>	520 <sup>1)</sup>	520 <sup>1)</sup>	520 <sup>1)</sup>	520 <sup>1)</sup>	520
4.22		Fork dimensions	s/e/l mm	51 / 160 / 810	51 / 160 / 810	51 / 160 / 970	51 / 160 / 970	51 / 160 / 1,140	51 / 160 / 1,140
4.25		Width across forks	b <sub>5</sub> mm	520 <sup>1)</sup>	520 <sup>1)</sup>	520 <sup>1)</sup>	520 <sup>1)</sup>	520 <sup>1)</sup>	520
4.32		Ground clearance, centre of wheelbase	m <sub>2</sub> mm	34	34	38	34	38	34
4.34		Aisle width for pallets 800 x 1200 lengthways	Ast mm	1,610	1,610	1,610	1,610	1,610	
Performance data	4.35	Turning radius	W <sub>a</sub> mm	1,000	1,000	1,160	1,160	1,330	1,330
	5.3	Lowering speed, laden/unladen	m/s	0.1 / 0.05					

<sup>1)</sup> 680 mm also possible

<sup>2)</sup> Width 520 mm

<sup>3)</sup> Ø 80x70 mm tandem tyres

# Benefit from the advantages



AM I20 controls



Enclosed fork tips

## Easy to operate

Smooth controls equally suitable for both left-handed and right-handed users. Sensitive and controlled lowering of loads with the special lowering valve.

## Optimum hygiene

The enclosed fork tips ensure that no dirt can spray up through the fork tips to the load. Freely accessible or fully enclosed cavities allow for effective cleaning with no hiding places for bacteria. Grease nipples on all moving parts and food-grade grease (class H1 and H2) complete

the solution.

## Fast transportation

The very short front end length of 340 mm allows for safe and easy operation even in confined spaces. Brackets on the fork tips enable the forks to extend and retract easily.

## Jungheinrich UK Ltd.

Head Office:  
Sherbourne House  
Sherbourne Drive  
Tilbrook  
Milton Keynes MK7 8HX  
Telephone 01908 363100  
Fax 01908 363180

info@jungheinrich.co.uk  
www.jungheinrich.co.uk

The German production facilities in Norderstedt, Moosburg and Landsberg are certified. **ISO 9001**  
**ISO 14001**

Jungheinrich fork lift trucks meet European safety requirements.



**JUNGHEINRICH**